

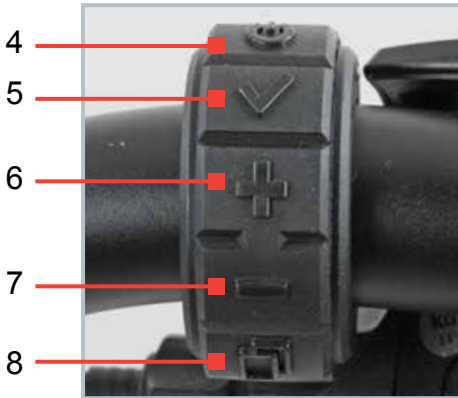

GC SwissDrive.

■ ORIGINAL INSTRUCTION MANUAL
EVO control unit





■ COMPONENT DESCRIPTION

- | | | | |
|---|------------------|----|----------------------|
| 1 | Display | 7 | -Key |
| 2 | Docking station | 8 | Scroll key |
| 3 | Handlebar remote | 9 | Lever display fixing |
| 4 | On/Off key | 10 | Fixing handlebar |
| 5 | Confirm key | 11 | Contacts |
| 6 | +Key | 12 | USB interface |

WELCOME

Dear Customer,

Thank you for choosing an Evo control unit. Our Evo control unit stands for high Swiss quality and it will give you a great deal of pleasure and together with your GO SwissDrive system enjoyment when riding.

The original instruction manual Evo control unit contains a great deal of important and detailed information on the operation, the proper use, its care and maintenance and also its technology. Take your time to read it through thoroughly.

Before setting off with your GO SwissDrive system for the first time, you should make a few basic settings, such as date, time and circumference of the tyre. If possible, have this setting done when you collect your pedelec/e-bike from the dealer. In case you want to do these settings on your own, be sure to strictly observe the instructions in this original instruction manual. In case you still have questions relating to the configuration or the setting after you have read the detailed original instruction manual, contact your dealer.

Please keep this original instruction manual in a safe place to answer any questions that might crop up later. Also make these instructions available if you lend or pass on your Evo control unit or your complete pedelec/e-bike to someone else.

We wish you a great deal of enjoyment and good riding with our Evo control unit.

The **GO SwissDrive** Team



NOTES ON THE ORIGINAL INSTRUCTION MANUAL

Pay particular attention to the following symbols:

 This symbol provides you with information about how to handle the product or refers to a passage in the original instruction manual that deserves your special attention.

 This symbol warns you of incorrect actions that could result in damage to property and the environment.

 This symbol indicates an imminent risk to your life or health unless you comply with the instructions given or take preventive measures.

This instruction manual complies with the standard DIN EN 15194, however, solely with regard to the drive components.

Imprint

© No part of this publication may be reprinted, translated, copied or transmitted in any form or by any means, electronic, mechanical, by hand or otherwise for another business purpose without prior written permission of GO SwissDrive AG and Zedler – Institut für Fahrradtechnik und -Sicherheit GmbH.

© **GO SwissDrive AG**
www.go-swissdrive.com

© **Zedler – Institut für Fahrradtechnik und -Sicherheit GmbH**
www.zedler.de

Edition 1, March 2015



1. INTRODUCTION

The Evo control unit is the communication interface with the GO SwissDrive system. It offers you a huge number of functions and individualisation options. The following chapter is a short overview with the description of the basic operation of the Evo control unit. You will find a detailed description of all functions and configuration options of the Evo control unit in the following chapters.

2. SHORT OVERVIEW

2.1. Components of the Evo control unit

The Evo control unit consists of three components (1):

- display (1a),
- docking station (1b) and
- handlebar remote (1c)

The **display** is the display unit of your Evo control unit.

The system is controlled by the keys of the **handlebar remote**.

The **docking station** connects the display with the other components of the GO SwissDrive system. In addition, the docking station has a USB port through which data can be transferred and cell phones can be charged up to a current of 1.0 A.



2.2. Mounting the display on the docking station

Mount the display on the upper edge of the docking station (2). Subsequently slide the display opposite to the direction of motion until it engages with an audible click in the docking station (3).

To remove the display press down the lever on the upper edge of the docking station and slide the display to the front until it can be removed (4).

i If you want to mount the display permanently on the docking station, it can be secured with a screw integrated into the docking station. To mount and remove the display the screw has to be unscrewed nearly fully by using a 3-mm Allen key. To secure the display with the screw, mount the display first and tighten the screw subsequently.

2.3. Operation of the Evo control unit

Your GO SwissDrive system is controlled by the handlebar remote, which can be mounted on the right or left side of the handlebars close to the grips.



The handlebar remote has five keys (1). Their functions are described in short in the following. For a detailed description see the chapter “**Key functions of the handlebar remote**”.

On/Off key (1a): With the On/Off key (and with any other key) you can activate the entire GO SwissDrive system. By pressing the On/Off key long you can turn off the system.

Confirm key (1b): With the Confirm key you can activate and disable various functions and select and confirm settings in the configuration menu.

1. **Main menu:** Turning on and off the lights by pressing the key long. Switching between manual mode, automatic mode and full beam by pressing the key shortly.

i The function is only available if your pedelec/e-bike has a compatible lighting system.

2. **Tour menu:** Manual deleting and clearing of the tour data by pressing the key long.

3. **Stopwatch menu:** Starting and stopping the measurement. Pressing the key long saves the current measurement and resets the stopwatch.

4. **Configuration menu:** Confirmation of selected options and settings.

+/-Keys (1c): With the +/-keys you can adjust the assistance level of the GO SwissDrive system during the ride. In the configuration menus the +/-keys can be used for navigation between the individual menu items.

1. **Assistance level:** Increasing or reducing the assistance level of the GO SwissDrive system (only in driving mode).

2. **Throttle mode (pushing aid):** Pressing the +key (2) long in the driving mode activates the throttle mode forward.

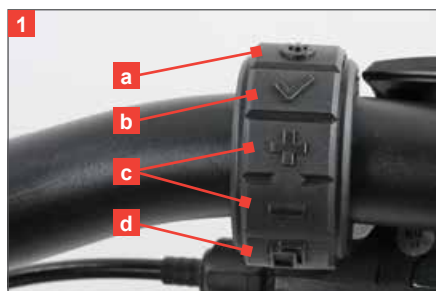

i If your vehicle has a throttle mode for moving backwards, this function is activated by pressing the -key long in the driving mode. This function is analogous to the throttle mode towards the front.

i The function can only be activated up to the adjusted speed limit of 0-6 km/h (pedelecs) or 0-20 km/h (speed pedelecs). Please note that the adjustability depends on country-specific statutory regulations.

3. **Navigation within the configuration menu:** Change to the previous/next menu item or value to be set.

4. Adjusting numerical values in the settings.

Scroll key (1d): With the Scroll key you can switch between the individual menus of your Evo control unit.

2.4. Menus in operation during the ride

The menu structure of your Evo control unit consists of different menus which are enabled depending on the riding situation.

! For road-safety reasons the menu selection is limited during the ride to the main menu, the tour data and the stopwatch.

In the driving mode the display of the Evo control unit is subdivided in **five sections (3)**:

- status bar (3a),
- display of the assistance level (3b),
- speed indicator (3c),
- menu position (3d) and
- variable section (3e) indicating different riding menus.

The **status bar** shows various symbols (4) giving you a quick overview of the current state of the system.



The currently selected **assistance level** is visualized by the graphics on the left edge of the display **(1)**. By means of the +/--keys you can select between five positive assistance levels and two recuperation levels. By pressing the +key you select a higher assistance level, by pressing the -key you select a lower assistance level. By selecting assistance level 0 the motor assistance is turned off.

The current **speed** of the pedelec/e-bike is indicated with one digit behind the decimal point.

i The speed is only indicated correctly if the circumference of tyre of your pedelec/e-bike is set correctly. You can adjust the circumference of tyre in the settings (see chapter “Configurations and settings”).

The menu structure of your Evo control unit consists of different menus which are enabled depending on the riding situation. In the **variable display section (2)** you can select between the main menu, an overview of the data relating to the current tour and a stop watch function. You can switch between these menus by pressing the Scroll key. The **menu position** indicates the current menu with a symbol.

2.5. Menus at standstill

Whenever your pedelec/e-bike stands still, further menus are enabled:

- overview of the total data,
- phone menu,
- service menu,
- menu for saving data on external devices and
- configuration sides.

You can switch between these menus by pressing the Scroll key.



i During the ride the Evo control unit disables the menus which are only available at standstill for road-safety reasons. If one of the standstill menus is enabled when you set off, the Evo control unit switches automatically to the main menu.

2.6. Basic settings

Before you set off with your GO SwissDrive system you should do a few basic settings. This applies in particular to the circumference of tyre, the preferred language as well as the date and the time.

Adjust the **circumference of tyre** in the configuration menu under “System settings”. The unit for the circumference of tyre is millimetre (mm).

To enter the data, call up the configuration menu **(3)** by pressing the Scroll key until the configuration screen appears. Continue by navigating with the +/-keys to the button “System settings” and then press the Confirm key.

Continue by navigating with the +/-keys to the button “Circumference of tyre” and then press the Confirm key **(4)**. You can now increase or reduce the circumference of tyre with the +/-keys. Finish by pressing the Confirm key.

i Keep in mind that the circumference of tyre is the basis of many calculations, such as the indicated speed, the distance you have ridden and the remaining range. If possible, have this setting done when you collect your pedelec/e-bike from the dealer.

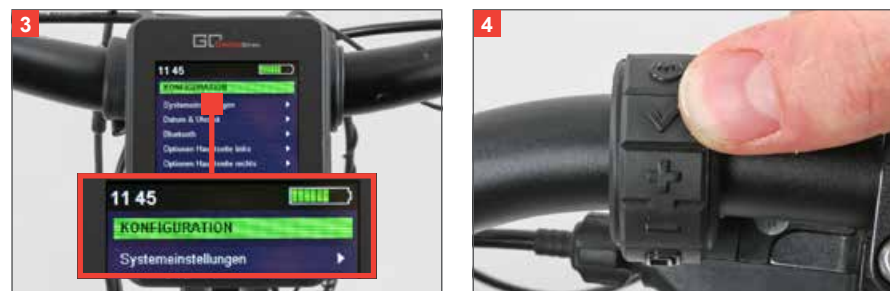

The **date and the time** can be adjusted in the configuration menu under “Date and time” **(1)**.

To enter the data, call up the configuration menu by pressing the Scroll key until the configuration screen appears. Continue by navigating with the +/-keys of the handlebar remote to the button “Date and time” and then press the Confirm key.

Now you can make the entries for hour, minute, day, month and year by navigating with the +/-keys to the respective buttons and by pressing the Confirm key subsequently. Now you can increase or reduce the respective value with the +/-keys. Finish by pressing the Confirm key.

The preferred **language** can also be selected in the configuration menu. To enter the data, call up the configuration menu by pressing the Scroll key until the configuration screen appears. Continue by navigating with the +/-keys of the handlebar remote to the button “System settings” and then press the Confirm key. Continue by navigating with the +/-keys to the desired language and then press the Confirm key again.



3. KEY FUNCTIONS OF THE HANDLEBAR REMOTE

Your Evo control unit is controlled by the handlebar remote, which can be mounted on the right or left side of the handlebars close to the grips. The handlebar remote **(2)** has **five keys**. Their functions are described in short in the following.

On/Off key (3): With the On/Off key (and with any other key) you activate the entire GO SwissDrive system. By pressing the On/Off key long you can turn off the system. The display should be activated shortly after you press this key and the entire system should be ready for use. By pressing once again the On/Off key somewhat longer the system is switched off.

Confirm key (4): With the Confirm key you can activate and disable various functions in the menu of your Evo control unit and select and confirm settings in the configuration menu. The function of the Confirm key hereby depends on the currently shown menu.

- Function in the main menu:** If your pedelec/e-bike has a compatible lighting system, you can switch on and off the lighting by **pressing long** on the Confirm key in the main menu. With the lighting switched on you can, in addition, select between manual mode, automatic mode and full beam by **pressing** the Confirm key **shortly**. In the automatic mode the lighting is controlled via a brightness sensor integrated into the display.
- Function in the tour data menu:** In the tour data menu you can clear the tour data manually by pressing the Confirm key long.



Keep in mind that the tour data recorded until then will be deleted irrevocably.

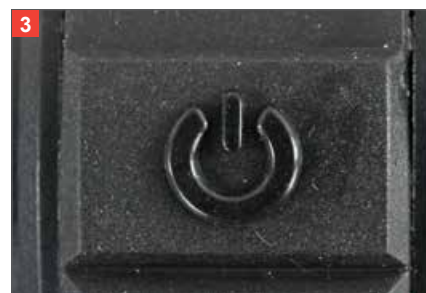

- Function in the stopwatch menu:** Start the stopwatch by pressing the Confirm key when the stopwatch menu is indicated. Pressing the Confirm key once again stops the measurement. Pressing the Confirm key long saves the measurement and resets the stopwatch. If you want to continue the measurement after a pause, just press the Confirm key once again.
- Function in the standstill menus:** At standstill the Confirm key serves to confirm selected options or the setting of parameters. After you have navigated with the +/-keys to the desired button, you can confirm the selection of the option or the execution of the function with the Confirm key. Examples for this function are the deleting of the calling list in the phone menu or the selection of a language in the system settings.

+/-Keys (1): With the +/-keys you can adjust the assistance level of the GO SwissDrive system during the ride.

- Selection of the assistance level:** With the +/-keys you can select between five positive assistance levels and two recuperation levels. By pressing the +key you select a higher assistance level, by pressing the -key you select a lower assistance level. By selecting assistance level 0 the motor assistance is turned off. The higher the assistance level, the more assistance is provided until you have reached the speed limit of the motor set by the manufacturer. The recuperation (the feeding back of recovered energy into the battery and the motor brake) is correspondingly strongest at the lowest level (-2) (2).
- Throttle mode:** Pressing the +key long in the driving mode activates the throttle mode to the front. Within the throttle mode the motor provides assistance without additional pedalling. This makes it easier for you to push the pedelec/e-bike up steep ramps or if the bicycle is heavily loaded. You need to push the pedelec/e-bike slightly by hand to make the throttle mode start. The assistance stops as soon as you release the key.



i If your vehicle has a throttle mode for moving backwards, this function is activated by pressing the -key long in the driving mode. This function is analogous to the throttle mode towards the front.

i The function of the pushing aid can only be activated up to the adjusted speed limit of 0-6 km/h (pedelecs) or 0-20 km/h (speed pedelecs). By means of the GO SwissDrive service tools your dealer can modify the maximum speed within this range. Please note that the adjustability depends on country-specific statutory regulations.

- Function in the standstill menus:** In the configuration menus you can navigate with the +/-keys between the individual buttons. By pressing the -key you navigate to the next line. If there is more than one option in one line, you navigate from the left to the right by pressing the -key. Analogous to that you navigate to the previous line by pressing the +key. If there is more than one option in one line, you navigate from the right to the left by pressing the +key.
- Setting numerical values:** There are certain parameters, such as the circumference of tyre, which request numerical inputs. These can be entered by pressing the +/-keys starting from a given value. The value is increased by 1 by pressing the +key and reduced by 1 by pressing the -key (3).

Scroll key (4): With the Scroll key you can switch between the individual menus of your Evo control unit. The series of the menus is predetermined and cannot be changed. You can, however, disable individual menus in the settings, if necessary. Disabled menus are skipped when you browse through.

By pressing long on the Scroll key you return from each other menu to the main menu (except: submenu of the configuration page).



4. OVERVIEW MENU STRUCTURE

The menu structure of your Evo control unit consists of different menus which are enabled depending on the riding situation.

For road-safety reasons the menu selection is limited during the ride to the main menu, the tour data and the stopwatch. At standstill further menus are enabled in which for example settings can be made or a mobile phone can be connected via Bluetooth.

4.1. Menus in operation during the ride

In the driving mode the display of your Evo control unit is subdivided into **five sections (1)**:

- status bar (1a),
- display of the assistance level (1b),
- speed indicator (1c),
- menu position (1d) and
- variable section (1e) indicating the three different riding menus.

The **status bar** shows various symbols giving you a quick overview of the current state of the system. A detailed description of the individual elements is given in the following chapter "Status bar".

The currently selected **assistance level** is visualised by the graphics on the left edge (2). By means of the +/--keys you can select between five positive assistance levels and two recuperation levels. By pressing the +key you select a higher assistance level, by pressing the -key you select a lower assistance level. By selecting assistance level 0 the motor assistance is turned off.

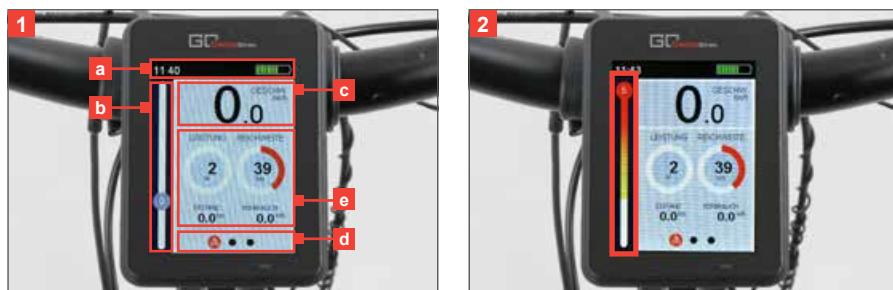

The higher the assistance level, the more assistance is provided until you have reached the end limit of the motor set by the manufacturer. The recuperation (the feeding back of recovered energy into the battery and the motor brake) is correspondingly strongest at the lowest level (-2).

The current **speed** of the pedelec/e-bike is indicated with one digit behind the decimal point (3). In the settings you can choose between a display in kilometres per hour (km/h) or in miles per hour (mph).

i The speed is only indicated correctly if the circumference of tyre of your pedelec/e-bike is set correctly. You can adjust the circumference of tyre in the settings (see chapter "Configurations and settings").

The **menu position** indicates the selected screen with a symbol.

In the **variable section** you can select between the main menu, an overview of the data relating to the current tour and a stop watch function. You can switch between these menus by pressing the Scroll key (4). A detailed description of these menus including respective functions is given in the chapters "Main menu", "Overview tour data" and "Stopwatch".

4.2. Menus at standstill

At standstill of the pedelec/e-bike, further menus are enabled:

- an overview of the total data,
- the phone menu,
- the service menu,
- a menu for saving data on external devices and
- the configuration pages.



You can switch between these menus by pressing the Scroll key. A detailed description of the individual menus is given in the respective chapters.

In the standstill mode the display of your Evo control unit is subdivided into three sections already described in the preceding section: the **status bar**, the **menu position** and a **variable menu section**, where you can select between the different standstill menus.



Keep in mind that during the ride the Evo control unit disables the menus which are only available at standstill for road-safety reasons. If one of the standstill menus is enabled when you set off, the Evo control unit switches automatically into the main menu.

5. STATUS BAR

The status bar is displayed in all menus at the top of the display. With various symbols it gives you a quick overview of the current operating state of your pedelec/e-bike. The meaning of the individual symbols is described in the following.

Time (1): The current time is displayed on the left side of the status bar. In the settings you can select the 12-hour or the 24-hour mode. By selecting the 12-hour mode AM (Ante Meridiem) or PM (Post Meridiem) is displayed in addition on the right side of the time.

Lighting (2): If your pedelec/e-bike has a compatible lighting system, its current state is visualised in the status bar: “On”, “Off”, “Automatic” or “Full beam”. By **pressing** the Confirm key **long** you switch on/off the light. When switched on, you can switch between the modes of operation by **pressing** the Confirm key in the main menu **shortly**.



Bluetooth (3): Your Evo control unit has an integrated Bluetooth chip and can be connected via Bluetooth 4.0 with compatible devices, such as for ex. mobile phones. Whether your mobile phone supports the Bluetooth 4.0 standard can be gathered from the operating manual of your mobile phone. The current state of the connection is visualised by means of the Bluetooth symbol. A blue coloured symbol means that the Bluetooth interface of the Evo control unit is activated. If the Bluetooth symbol is not displayed in the status bar, the Bluetooth interface is disabled.

Phone (4): If your Evo control unit is connected via Bluetooth with a mobile phone, this is visualised with the phone symbol in the status bar. An incoming call or SMS on the mobile phone is indicated on the display. First, you will see a pop-up appearing shortly (see chapter “Pop-ups and warnings”). Subsequently, a list symbol (5) is displayed with the phone symbol in the status bar. This symbol will remain displayed until the phone menu of the Evo control unit has been called up (see chapter “Phone menu”).



Service tool (1): Your well-equipped dealer has the GO SwissDrive service tool. With this tool he can make various settings on your pedelec/e-bike. Once the display is connected via the USB or Bluetooth interface with the service tool, this is visualised by means of the service tool symbol.

Error (2): An error occurring in the GO SwissDrive system of your pedelec/e-bike is indicated on the display. First, you will see a pop-up appearing shortly (see chapter “Pop-ups and warnings”). Subsequently, the error symbol is displayed in the status bar. Further information on the existing error and possibly necessary measures are described in the service menu (see chapter “Service menu”). The error symbol disappears when the service menu has been called up or when the error is no longer existing.

Temperature warning (3): The display can show early warnings to prevent possible errors in the GO SwissDrive system at an early stage. This includes in particular the warning concerning overheating of the motor and the battery. Before the motor or the battery overheat and correspondingly begin to reduce their performance for system protection reasons, you are informed on the display.

First, you will see a pop-up appearing shortly (see chapter “Pop-ups and warnings”). Subsequently, the temperature warning symbol appears in form of a thermometer on the status bar, as long as motor or battery exceed the temperature warning threshold. As soon as the temperature drops below the warning threshold the symbol disappears from the status bar.



Adapt your riding style and/or the assistance level according to these warnings to avoid a temporary reduction or even a complete loss of the drive assistance. This is achieved by either reducing the assistance level or by shifting into a lower gear with lower gear ratio in order to reduce the temporary overload of the drive components.

Battery state of charge (4): The battery symbol on the right side of the status bar shows the battery’s current state of charge. The symbol has 9 bars, each bar corresponding to 10% of the battery capacity. A detailed description of the battery symbol in relation to the state of charge is given in the table below.

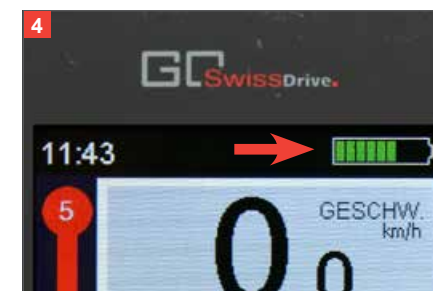
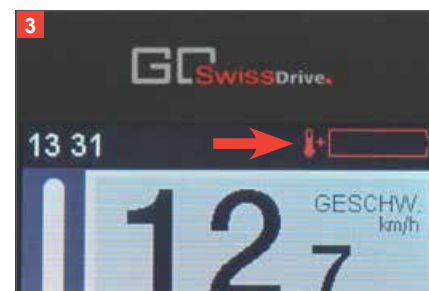
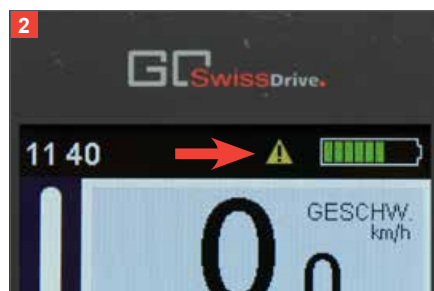
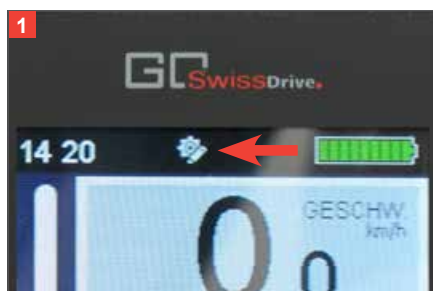

Display	Battery state of charge
	100% - 90%
	89% - 80%
	79% - 70%
	69% - 60%
	59% - 50%
	49% - 40%
	39% - 30%
	29% - 20%
	19% - 10%
	9% - 0%

20

When the motor is operated in the recuperation mode, this is visualised with a white-coloured bar (1).



The charge control indicator always refers to the current capacity of the battery. In this connection, keep in mind that the maximum chargeable capacity of a battery may decrease with a growing number of charging cycles.

6. MAIN MENU

The main menu provides the essential information required during the ride. This menu is displayed by default whenever you switch on the GO SwissDrive system.

Besides the display of the assistance level and the current speed which is obligatory for the riding menus indications regarding the current performance of the GO SwissDrive system and the remaining range are shown here.

The current performance is indicated with a three-digit value in watts (W). When the motor is operated in the recuperation mode, this is visualised with a negative performance value. In addition, the current performance is visualised with an analogous circular instrument (2).



Keep in mind that the indication of the current performance is based on battery data. Depending on the battery type used there can be a minor time delay between the display and the actual performance.

21

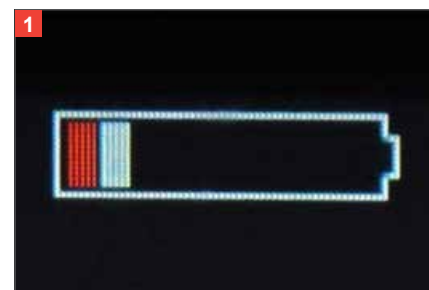

The remaining range is indicated with a three-digit value in kilometres or miles. In addition, the remaining range is visualised with an analogous circular instrument (1). The algorithm for the calculation of the remaining range not only considers the total distance ridden with the pedelec/e-bike (total data), but also the last kilometres. With an increasing total distance the algorithm therefore adapts more and more to your riding behaviour and hereby allows forecasts for the remaining range to become more and more precise.



Keep in mind that the indicated remaining range is only an approximate forecast. Due to the route profile, the selected assistance level and many other factors there may be deviations between the indicated value and the actual remaining range.

The lower section of the main menu (2) can be configured according to your own wishes by selecting up to two parameters from the current tour data which will be shown on the display. You can select between the following indications:

- the distance covered,
- the power consumption since the beginning of the tour,
- the mean speed,
- the maximum speed and
- the actual ride time.

The configuration is made in the settings. More information in this regard is given in the chapter "Configuration and settings".



7. OVERVIEW TOUR DATA

The second riding menu gives you a compact overview about your current tour (3).

There you will find information

- on the distance covered (3a),
- on the power consumption since the beginning of the tour (3b),
- on the mean speed (3c),
- on the maximum speed (3d) and
- on the actual ride time (3e).

You can determine the start point of a tour on your own. In this regard the Evo control unit offers you three different options: When the tour menu is indicated, you can reset the tour data whenever you want by pressing the Confirm key long and then start a new tour (4).

Furthermore, you can reset the tour manually in the settings or determine that the tour data are automatically reset after every stop longer than four hours so that a new tour is started when you switch on the display again. More information in this regard is given in the chapter "Configuration and settings".



The tour data are only indicated correctly if the circumference of tyre of your pedelec/e-bike is set correctly. You can adjust the circumference of tyre in the settings (see chapter "Configurations and settings").



8. STOPWATCH

With the stopwatch function (1) of your Evo control unit you can stop the time taken for a distance covered. Each measurement consists of a time measurement and the distance covered which is indicated in kilometres or miles.

Start the stopwatch by pressing the Confirm key when the stopwatch menu is indicated.

Pressing the Confirm key once again stops the measurement (2). Pressing the Confirm key long saves the measurement and resets the stopwatch. If you want to continue the measurement after a pause however, just press the Confirm key once again.



Keep in mind that only the two last measurements will be saved. By saving a new measurement an older measurement is deleted.



The distance covered is only indicated correctly if the circumference of tyre of your pedelec/e-bike is set correctly. You can adjust the circumference of tyre in the settings (see chapter "Configurations and settings").

24

9. OVERVIEW TOTAL DATA

At standstill of your pedelec/e-bike further menus are enabled which provide useful information and settings. The first of these menus give you a compact overview of the lifetime data of your pedelec/e-bike.



The menu is structured analogous to the tour menu. There you will find information

- on the total distance covered (3a),
- on the total power consumption since the beginning of the tour (3b),
- on the mean speed (3c),
- on the maximum speed (3d) and
- on the total ride time (3e).

Unlike the tour data, the total data cannot be changed or cleared by you.



The total data are only indicated correctly if the circumference of tyre of your pedelec/e-bike is set correctly. You can adjust the circumference of tyre in the settings (see chapter "Configurations and settings").

10. PHONE MENU

Your Evo control unit offers you the option to connect a mobile phone via Bluetooth 4.0. Instructions on how to connect a mobile phone are given in the chapter "Configurations and settings". Whether your mobile phone supports the Bluetooth 4.0 standard can be gathered from the operating manual of your mobile phone.

When your Evo control unit is connected with a mobile phone, incoming calls and SMS are shown on the display. First, you will see a pop-up appearing shortly (see chapter "Pop-ups and warnings") (4).



25

Subsequently, a list symbol (1) is displayed with the phone symbol in the status bar indicating that a new call or a new SMS was registered in the phone menu. In the list the calls and SMS are sorted by date and time whereas the latest call or the latest SMS are indicated at the top. If the number of the incoming call or incoming SMS is recorded in the phone book of your mobile phone, the name recorded in your mobile phone instead of the phone number is indicated in the list.

You can delete the list of incoming calls and SMS by navigating with the +/-keys of the handlebar remote to the "Delete list" button and by pressing the Confirm key.



For road-safety reasons you should always stop before using your mobile phone.



Keep in mind that only the list recorded in your Evo control unit is deleted. The information in your mobile phone is neither changed nor deleted by that.



The phone menu of your Evo control unit is a pure visualisation of the data of your mobile phone. You cannot answer or make any calls with the Evo control unit.

11. DATA STORAGE

Your Evo control unit offers you the option to save your current tour data and your total data via the USB interface or the Bluetooth interface on an external device.



To ensure a trouble-free function the external storage device (e.g. USB stick) must be formatted to FAT32.



If an external device is connected with the Evo control unit via one of these two interfaces, you can select one of four storage variants in the menu "Data storage" (2) by navigating with the +/-keys of the handlebar remote to the desired button and start the saving process by pressing the Confirm key. The currently marked button is highlighted green. The successful storage of the data on the external device is confirmed by the display with a pop-up (3).

12. SERVICE MENU

In the event of an error of the GO SwissDrive system, the service menu (4) offers you compact instructions to fix this error.

There is a list with the latest errors occurred. Each error indicator consists of a letter and a two-digit number. With the letter the component concerned by the error can be identified.

- M: motor error
- D: display error
- B: battery error
- C: communication error

In case of a communication error the communication between the individual system components is disturbed. Even if the components themselves still work trouble-free, the system changes into the error mode for safety reasons. It often suffices to check the cables and the connectors to remedy the communication problems.

i The error indicator is completed with possible corrective measures in concise form. In case the error cannot be remedied with these measures, have the pedelec/e-bike checked by a dealer.

You can delete the list of errors occurred by navigating with the +/-keys of the handlebar remote to the “Delete list” button (1) and by pressing the Confirm key.

In addition, the service menu shows the time or the mileage for the next service at your dealer under the error list.

i The indication of the service interval depends on the manufacturer of your pedelec/e-bike. If this function is disabled, no information is shown in this area.

13. CONFIGURATION AND SETTINGS

You can make various basic settings in the configuration menu (2) and, in addition, adjust the Evo control unit to your particular needs and requirements.

i In case there will arise any questions or problems during the configuration of the Evo control unit described in the following, contact your dealer.

The configuration menu is divided into **six different submenus** which you select by navigating with the +/-keys of the handlebar remote to the desired button and by pressing the Confirm key.



The currently marked button is highlighted green (3). From a submenu you can return to the main menu by navigating to the “Configuration” button at the top of the submenu – which is highlighted green – and by pressing the Confirm key of the handlebar remote subsequently.

Within the submenu you can switch between the different buttons with the +/-keys of the handlebar remote whereas the currently marked button is highlighted green. If you can select between several options for one setting, the currently active option is highlighted grey and checkmarked. To enable another option navigate with the +/-keys to the desired option and press the Confirm key.

For numerical settings, such as e.g. the circumference of tyre, navigate with the +/-keys of the handlebar remote to the desired button and press the Confirm key. Now you can increase or reduce the value by pressing the +/-keys.

Pressing the +key increases the respective parameter by 1, pressing the –key reduces the respective parameter by 1.

By pressing the +/-keys long you can enable the fast-forward which remains enabled as long as you press the key. Once the desired value is reached, you can save it by pressing the Confirm key.

A full description of the individual submenus is given in the following chapters.

13.1. System settings

In the submenu “System settings” (4) you can make various basic settings of your system.



For the **display of the distances and speeds** you can select between the metric system and the imperial system. In the metric system distances are displayed in kilometres (km) and the speeds in kilometres per hour (km/h); in the imperial system distances are displayed in miles (m) and speeds in miles per hour (mph).

Your Evo control unit offers various **menu languages** between which you can select. The possible options depend on the configuration of the manufacturer of your pedelec/e-bike. The languages German and English are available as standard.

With the **parameter “Power off after min” (1)** you can set after how many minutes without input and movement of your pedelec/e-bike you want the system to switch off to save energy.

i Make sure the time set is not too short to avoid that the system switches off unintentionally, e.g. during a rather long stop in front of red traffic lights. In case the system nevertheless switches off unintentionally, you can enable it with the On/Off key of the handlebar remote or with any other key at any time.

The Evo control unit has an integrated brightness sensor. This sensor adapts the display's backlighting automatically to the ambient brightness. You can increase or reduce the basic brightness via the parameter “Brightness”. When the parameter is set to 100% the automatic control is disabled and the backlighting is always at maximum regardless of the ambient brightness.

i The automatic brightness sensor is not enabled in all variants of the Evo display. In these variants you can set the display brightness manually in three steps.

With the **parameter “Circumference of tyre” (2)** you can enter the circumference of tyre of your pedelec/e-bike into the system. The unit for the circumference of tyre is millimetre (mm).



Keep in mind that the circumference of tyre is the basis for many calculations, such as the indicated speed, the distance you have ridden and the remaining range. If possible, have this setting done when you collect your pedelec/e-bike from the dealer.

If you enable the **option “Clear tour after 4h autom.” (3)**, the tour data are deleted after each standstill longer than four hours. The next time the display is switched on the tour data will be reset.

In this menu, you can furthermore clear the tour data manually with the button “Clear tour” at any time.

13.2. Date and time

In the submenu “Date and time” (4) you can set the date and the current time.

Furthermore, you can select between a time indication in the 24-hour mode or in the 12-hour mode. In the 12-hour mode the indication AM (Ante Meridiem) or PM (Post Meridiem) is displayed in addition on the right side of the time in the status bar.

13.3. Bluetooth

Your Evo control unit has an integrated Bluetooth chip and can be connected via Bluetooth 4.0 with various compatible devices, such as for ex. mobile phones. Whether your mobile phone supports the Bluetooth 4.0 standard can be gathered from the operating manual of your mobile phone.

To connect a compatible mobile phone you have to enable the Bluetooth interface of this mobile phone first. For more details in this regard see the operating manual of your mobile phone.



In the next step enable the Bluetooth interface of your Evo control unit by navigating in the submenu "Bluetooth" (1) to the button "Enable Bluetooth" and press the Confirm key subsequently.

Now, your Evo control unit tries to set up a connection with a mobile phone in the vicinity. To allow the connection with the mobile phone, open the GO SwissDrive App "EvoConnect" on the mobile phone, select your Evo control unit and confirm the request regarding the set up of a Bluetooth connection.

i To set up a Bluetooth connection with a mobile phone the GO SwissDrive App must be installed on this mobile phone. You can download the GO SwissDrive App "Evo Connect" from the Apple App Store (iOS devices) or the Google Playstore (Android devices).

13.4. Options main menu

The Evo control unit offers you the option to configure the lower section of the main menu (2) according to your own wishes by selecting up to two parameters from the current tour data which will be shown on the display.

You can select between the following indications:

- the total distance covered,
- the total power consumption since the beginning of the tour,
- the mean speed,
- the maximum speed and
- the total ride time.

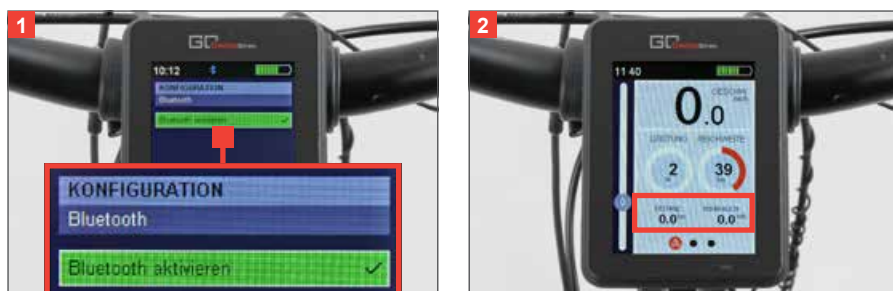

The currently active parameter is highlighted grey and checkmarked (3).

To enable another parameter navigate with the +/-keys of the handlebar remote to the desired option and press the Confirm key. If you want to disable the currently active parameter without selecting a new parameter, navigate with the +/-keys to the active parameter and press the Confirm key. In this case no parameter is indicated at the respective position in the main menu.

13.5. Screen selection

To adjust your display still more to your individual needs, the Evo control unit offers you the option to disable individual menus completely (4). These screens are then no longer displayed when you scroll through the menu structure.

In this way you can adjust the quantity of information displayed according to your needs. The currently active menus are highlighted grey and checkmarked. In case you want to change the state of a menu, navigate with the +/-keys of the handlebar remote to the desired menu and press the Confirm key.

i Keep in mind that the main menu and the configuration menu cannot be disabled.

14. POP-UPS AND WARNINGS

The Evo control unit informs you with pop-ups about certain incidents and operating states. A pop-up opens for the duration of four seconds and then disappears automatically. The meaning of the individual pop-ups is described in the following.



Bluetooth (1): The Evo control unit has an integrated Bluetooth chip and can be connected via Bluetooth 4.0 with various compatible devices, such as for ex. mobile phones. When a new Bluetooth connection was set up, you are informed with a pop-up.

Whether your mobile phone supports the Bluetooth 4.0 standard can be gathered from the operating manual of your mobile phone. Details on how to connect a mobile phone are given in the chapter "Configurations and settings".

Incoming calls (2): If your Evo control unit is connected via Bluetooth with a mobile phone, calls coming in on this mobile phone are visualised with a pop-up on the Evo display. If the number of the caller is stored in the phone book of the connected mobile phone, the contact data recorded together with the number (name, first name) are shown in the pop-up. If the number is not stored in the phone book, only the phone number is displayed.

Incoming SMS (2): If the Evo control unit is connected via Bluetooth with a mobile phone, SMS coming in on this mobile phone are visualised with a pop-up on the Evo display. If the number of the sender is stored in the phone book of the connected mobile phone, the contact data recorded together with the number (name, first name) are shown in the pop-up. If the number is not stored in the phone book, only the phone number is displayed.

Battery state of charge (3): In case the battery state of charge of your GO SwissDrive system drops below 20%, you are informed about this fact with a pop-up. A further indication is shown in form of a pop-up, when the battery state of charge drops below 10%.

Storage of data (4): The Evo control unit offers you the option to save your current tour data and your total data via the USB interface or the Bluetooth interface on an external device. The successful storage of the data on the external device is confirmed by the display of a pop-up.



In case a greater volume of data is saved, individual pop-ups visualise the beginning and the successful end of the saving process. If an error occurs during the saving process, another pop-up opens with the respective information.

No external device connected (5): If you try to save data via the USB interface or the Bluetooth interface and there is no external device connected with these interfaces, a respective indication is shown in form of a pop-up.



Early warnings (6): To avoid a possible overload of your GO SwissDrive system the Evo control unit can indicate early warnings. This includes in particular the warning concerning overheating of the motor and the battery. Before the motor or the battery overheat and correspondingly begin to reduce their performance for system protection reasons, you will be informed on the display.

i Adapt your riding style and/or the assistance level according to these warnings to avoid a temporary reduction or even a complete loss of the drive assistance. This is achieved by either reducing the assistance level or by shifting into a lower gear with lower gear ratio in order to reduce the temporary overload of the drive components.



15. CHARGING A MOBILE PHONE VIA USB CONNECTION

The docking station (1) of your Evo control unit has a USB interface (2). The USB interface can be used either for the transfer of data or for charging a mobile phone. To charge a mobile phone connect the mobile phone via USB cable with the USB interface of the docking station. The charging process starts as soon as the connection is set up.

-  Keep in mind that you can only charge a mobile phone with the GO SwissDrive system switched on. The maximum charging current is 1.0 A. The rated charging voltage is 5V.
-  The availability of the charging function depends on your pedelec/e-bike. Some cable looms have fuses for protection reasons. They may limit the available charging current significantly.

16. GENERAL INFORMATION ON THE HANDLING OF THE EVO CONTROL UNIT

Treat your Evo control unit with the adequate care. The housing is made of plastics and inside there are sensitive electronic components. Do not puncture or deform it, do not expose it to open flames, great heat or liquids and do not let it drop.



Do not use your Evo control unit if it is damaged. There may be the risk of unforeseeable damage. Contact your dealer immediately.



Do not remove or mount the display if you are in a potentially explosive area (e.g. petrol filling stations).



The display of your Evo control unit is protected against dust and spraying water according to IP65. However, remove the display from its mount (3) and stow it safely when transporting your pedelec/e-bike by car or on a trailer.



Do not mount the display on the docking station if the contact surfaces are moist or soiled. In some circumstances this can result in malfunction or short-circuits during the ride.



Do not transport the display together with sharp-edged objects (keys, pocket knives), to avoid scratches and damage.



Do not expose the display to high temperatures, e.g. near sources of heat or behind car windows during periods of intense sunshine.



Make sure no moisture penetrates the mount via the USB opening. Keep the cover closed (4) when the USB port is not used.



Always switch off your GO SwissDrive system before you remove the display from the docking station.



17. SERVICING AND MAINTENANCE OF THE EVO CONTROL UNIT

17.1. Servicing the Evo control unit

Clean your Evo control unit (1) immediately when it comes in contact with substances which may result in spot formation (e.g. thinners, benzene, ink, make-up etc.). Use a soft, lint-free and dust-collecting rag (2) for cleaning.



Do not use cleaning agents containing alcohol.



Do not use cleaning and abrasive agents, as they may damage the display.



Do not use garden hoses, steam jets or compressed air for cleaning.



Make sure the USB cover is always closed when you clean the display.



17.2. Maintenance of the Evo control unit

In general, your Evo control unit is maintenance-free. Exception: Replacement of internal battery.



Ask an authorised dealer to replace the battery of your Evo control unit.



Do not try to repair your Evo control unit on your own. Opening the display (3), the docking station (4) or the handlebar remote results in the expiry of the warranty and of any guarantee. Have the maintenance work only carried out by an authorised dealer.



Any change to or modification of the Evo control unit can affect the electromagnetic compatibility (EMC) and result in unwanted processes.



18. TECHNICAL DATA

The following table lists an overview of the most important technical data of your Evo control unit.

Parameter	Min. value	Type value	Max. value	Unit
Temperature range storage	-30		+80	°C
Temperature range operation	-20	25	+60	°C
Temperature range USB charging function	-10	25	+40	°C
Voltage range USB charging function	4.75	5.0	5.25	V
Current USB charging function			1.0	A
Supply voltage	24	36	70	V
Protection class display		IP65		
Consumption active		1.25		W
Consumption switched off			500	µW
Weight display		92		g
Weight docking station incl. handlebar remote		60		g
Torque value bolts docking station		0.3	0.5	Nm
Torque value safety bolt		0.3	0.5	Nm
Torque value bolt handlebar remote		0.1	0.3	Nm



Industriestrasse 4
P.O. Box 159
CH-9473 Gams
SWITZERLAND

info@go-swissdrive.com
www.go-swissdrive.com